



Technical Specifications



MOBOTIX T26B Door Station Camera

Hemispheric Door Station. Better Overview, More Security.

The high-resolution, hemispheric IP Video Door Station from MOBOTIX is an innovative, powerful solution that is easy to install. The T26 is based on the VoIP/SIP Video Intercom standard. All the modules offered for outdoor areas are weatherproof and maintenance-free and can be used in temperatures ranging from -30°C to 50°C (-22°F to 140°F).

- Mx6 system platform with H.264 and ONVIF compatibility
- Recording with sound, integrated mailbox function
- Available in day or night variants (6MP color or B&W sensor)
- Equipped with shock detector and MxAnalytics as standard
- Installation via CAT cable or two-wire cable
- Two-way video communication around the world
- Available in white, silver, dark gray or black

Please note:

As an alternative to the T26B, the S16B and T26B can also be used as a door station camera alternative.

A camera change from T25 to T26 in an existing door station is possible with further use of the other modules of the outdoor station after a system reconfiguration.



Camera Variants	T26B Day Doorstation Camera	T26B Night Doorstation Camera
Specialties	Factory-assembled T26B Day or Night camera with sharply focused fisheye special lens, available in four housing colors	
Comparable standard colors (not exactly the MOBOTIX colors)	White: RAL 9016, Silver: RAL 9006, Dark Gray: DB 703, Black: RAL 9005	
Objektive	T26B Day Doorstation Camera	T26B Night Doorstation Camera
Fisheye lens MX-B016 (f/2.0, Hemispheric 180° x 180°)	Mx-T26B-6D016 (white) Mx-T26B-6D016-b (black) Mx-T26B-6D016-s (silver) Mx-T26B-6D016-d (dark gray)	Mx-T26B-6N016 (white) Mx-T26B-6N016-b (black) Mx-T26B-6N016-s (silver) Mx-T26B-6N016-d (dark gray)
Hardware	T26B Day Doorstation Camera	T26B Night Doorstation Camera
Image sensor with individual exposure zones	Color	Black & White
Light sensitivity in lux at 1/60 s and 1/1 s	0.1/0.005	0.02/0.001
Image sensor (color or B/W sensor)	1/1.8" CMOS, 6MP (3072 x 2048), Progressive Scan	
Microprocessor	i.MX 6 Dual Core incl. GPU (1 GB RAM, 512 MB Flash)	
H.264 Hardware Codec	Yes, bandwidth limitation available; output image format up to QXGA	
Protection classes	IP65 and IK10	
Intended use	Not for use in hazardous areas (Ex area)	
Ambient temperature (range, incl. storage)	-30 to 50°C/-22 to 122°F (cold boot from -30°C/-22°F)	
Internal DVR, ex works	4 GB (microSD)	
Microphone/Speaker	Yes/Yes	
Passive infrared sensor (PIR)	No	
Temperature sensor	Yes (live and audio messages)	
Shock detector (tamper detection)	Yes	
Power consumption (typically at 20°C/68°F)	5 watts	
PoE Class (IEEE 802.3af)	Class 2 or 3 (variable), factory setting: class 3	
Interfaces	1x Ethernet 100BaseT (MxRJ45), 1x Ethernet 10/100 (LSA), MxBus, MiniUSB (MxMiniUSB), microphone, speaker	
Interface RS232	With MX-232-IO-Box (Order Nr: MX-OPT-RS1-EXT)	
Mounting options	Wall	
Dimensions (Height x Width x Depth)	99 x 99 x 60 mm	
Weight	265 g	
Housing	PBT-30GF	
Standard delivery	Screws, dowl, cable plug, Allen wrench, Screw driver, 0,5 m Ethernet patch cable, Quick Install	
Detailed technical documentation	www.mobotix.com > Support > Download Center	
Online version of this document	www.mobotix.com > Support > Download Center	
MTBF	> 80,000 hours	

Hardware	T26B Day Doorstation Camera	T26B Night Doorstation Camera
Certifications	EN55022:2010; EN55024:2010; EN50121-4:2006 EN61000-6-1:2007; EN 61000-6-2:2005 EN61000-6-3:2007+A1:2011 EN61000-6-4:2007+A1:2011 AS/ NZS CISPR22:2009+A1:2010 CFR47 FCC part15B	
Protocols	IPv4, IPv6, HTTP, HTTPS, FTP, FTPS, RTP, RTSP, UDP, SNMP, SMTP, DHCP (client and server), NTP (client and server), SIP (client and server) G.711 (PCMA and PCMU) and G.722	
Manufacturer's warranty	3 years	
Image Formats, Frame Rates, Image Storage	T26B Day Doorstation Camera	T26B Night Doorstation Camera
Available video codecs	MxPEG/MJPEG/H.264	
Image formats	Freely configurable format 4:3, 8:3, 16:9 or customized format (Image Cropping), such as 2592x1944 (5MP), 2048x1536 (QXGA), 1920x1080 (Full-HD), 1280x960 (MEGA)	
Multistreaming	Yes	
Multicast stream via RTSP	Yes	
Max. image format	6MP (3072 x 2048)	
Max. frame rate (fps, only single core used)	MxPEG: 42@HD(1280x720), 34@Full-HD, 24@QXGA, 15@5MP, 12@6MP MJPEG: 26@HD(1280x720), 13@Full-HD, 9@QXGA, 5@5MP, 4@6MP H.264: 25@Full-HD, 20@QXGA	
Number of images with 4 GB microSD (internal DVR)	CIF: 250.000, VGA: 125.000, HD: 40.000, QXGA: 20.000, 6MP: 10.000	
General Functions	T26B Day Doorstation Camera	T26B Night Doorstation Camera
Digital zoom and pan	Yes	
ONVIF compatibility	Yes (Profile S)	
Genetec protocol integration	Yes	
Programmable exposure zones	Yes	
Snapshot recording (pre/post-alarm images)	Yes	
Continuous recording with audio	Yes	
Event recording with audio	Yes	
Time controlled flexible event logic	Yes	
Weekly schedules for recordings and actions	Yes	
Event video and image transfer via FTP and email	Yes	
Playback and QuadView via web browser	Yes	
Bidirectional audio in browser	Yes	
Animated logos on the image	Yes	
Master/Slave functionality	Yes	
Privacy zone scheduling	Yes	
Customized voice messages	Yes	
VoIP telephony (audio, alert)	Yes	
Remote alarm notification (network message)	Yes	
Programming interface (HTTP-API)	Yes	
DVR	Inside camera via microSD card, externally via USB device and NAS, different streams for live image and recording, MxFFS with archive function, pre-alarm an post-alarm images, monitoring recording with failure reporting	

General Functions	T26B Day Doorstation Camera	T26B Night Doorstation Camera
Camera and data security	User and group management, SSL connections, IP-based access control, IEEE802.1x, intrusion detection, digital image signature	
MxMessageSystem: Sending and receiving of MxMessages	Yes	
Video Analysis	T26B Day Doorstation Camera	T26B Night Doorstation Camera
Video Motion Sensor	Yes	
MxActivitySensor	Yes	
MxAnalytics	Yes (Heatmaps, counting corridors and behavioural detection)	
Video Management Software	T26B Day Doorstation Camera	T26B Night Doorstation Camera
MxManagementCenter	Yes	
Mobile MOBOTIX App	Yes	

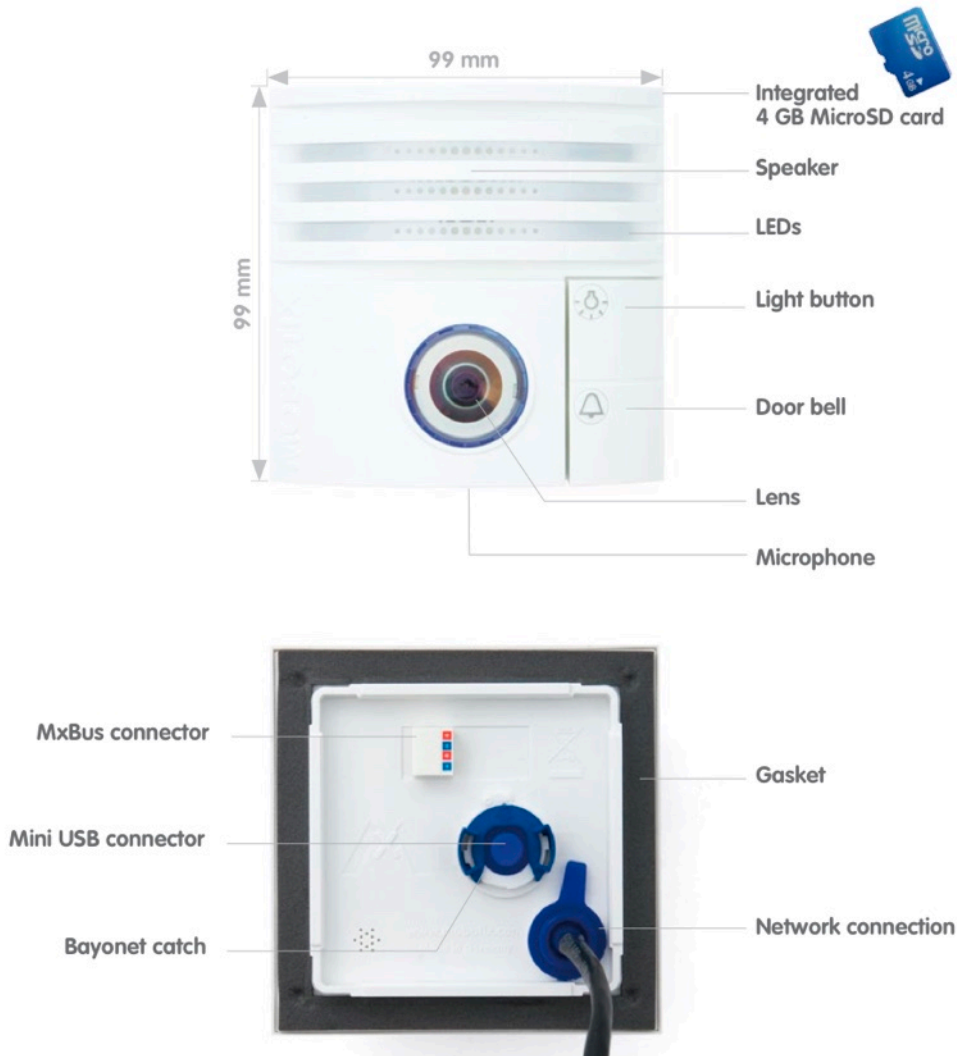

Safety Warning: Risk Of Overheating When Exposed To Direct Sunlight

When mounting a black or dark gray T26 IP Video Door Station in locations where the device is exposed to **direct sunlight**, the housing temperature can exceed the maximum allowed temperature limit. This can result in electronic failures and injuries especially when touching exterior metal parts. If the intended use of the device is at an (unprotected) outdoor location, you should only install **white or silver-colored** modules and frames. This product must not be installed within the reach of persons without the dome.

T26B Door Station and Access Modules: CamCore, Keypad, BellRFID



Intelligent. Powerful. Flexible.

The T26B with the latest Mx6 platform is here and the MOBOTIX product range of intelligent IoT systems is now complete! Outwardly unchanged compared to the T25 predecessor models, the innovations are in the inner workings. The change to the Mx6 dual core microprocessor technology offers above all an increase in performance, which benefits all computer-intensive image analysis functions such as MxAnalytics and thus enables higher frame rates.

Market opening with the industry standard ONVIF-S



The T26B camera platform also meets the requirements of the global, open interface standard ONVIF-S. In addition to the video codecs MxPEG and MJPEG, an H.264 stream can now also be generated. This makes MOBOTIX customers much more flexible and efficient when planning security solutions from individual components (cameras, recording devices, accessories, VM software).

Cost-effective modular system: T26B uses the accessory program of the T25 / T24 predecessor



The new T26B door station cameras are again available in the four familiar colors white, silver, dark gray and black, each with high-resolution 6MP day or night sensors. They can be combined with the same frames, housings, access modules, remote stations and accessories as the predecessor systems T25 and T24. An update only of the camera module is also technically possible with existing door stations.

Flexibility as a special advantage of the modular MOBOTIX IP Video Door Stations

Hardly any other manufacturer offers as many combination and usage options as MOBOTIX. Our Hemispheric Video Technology once again forms the centerpiece of the high-resolution T26. The modular system enables secure, keyless door opening via access code, RFID transponder and smartphone. In combination with several door stations, cameras and additional devices, individual access solutions of any size can be realized simply and inexpensively thanks to the IP standard.



With the new **MX-V5.2.0.x** firmware, the MOBOTIX cameras **S26B** and **S16B** (equipped with MxBUS connectors) can also be configured as door stations and used for individual installation solutions. The S26B with integrated miniature sensor module in the camera body can be concealed in the mailbox. With its two sensor modules positioned up to three meters from the housing, the S16B can even cover two areas at the same time (e.g., outside area and foyer).

T26B Camera Module (CamCore): Door camera with allround view with no blind spots



The hemispheric 360° lens covers the entire entrance area. No blind spots from wall to wall, from floor to ceiling. The camera can record events automatically, for example, when someone rings the doorbell or something moves in front of the door. The camera module can be used with a remote station as a compact basic Video Door Station, thanks to the integrated doorbell and light button. The 4 GB micro SD card can save 250 one-minute video clips or 60,000 individual VGA images.

BellRFID: A module for one to five bell buttons

The weatherproof BellRFID bell button module enables keyless entry via RFID transponder. The six different bell button sets can be easily replaced as required. Visitors can tap to leave messages, which can then be played back locally or remotely by residents.



KeypadRFID: Open door via PIN code or RFID card

The weatherproof KeypadRFID module enables keyless entry via RFID transponder and / or number combination, ringing at any number of remote stations via programmable key combinations and configuration of the Door Station without a PC. Includes mailbox function and transponder in check card format.



***Please note:** Since a previously used electronic module is no longer available on the market, all variants of BellRFID and KeypadRFID will each receive a successor model with identical appearance and functionality as part of a technically required facelift, but with new order numbers (see below). Initially, these new access modules can only be used in conjunction with the T26B and S26B / S16B. At the beginning of 2019, when the firmware update MX-V4.7.x is available for P3 cameras (x14 / x15 and x24 / x25), they can also be used with the T24 / T25 and S15M / S15D. All access modules delivered before the facelift are also compatible with the T26B and S26B / S16B.*

Info Module: Can also be connected via two-wire cable

The info module features a backlit house number field and can optionally include a Mx2wire+ unit. This unit is needed if the outdoor station is to be connected to the PoE switch with an existing bell wire via a second Mx2wire+ Indoor Unit instead of directly using an Ethernet cable.



MX-DoorMaster: Door opener module with battery power backup

The optional MX-DoorMaster with access code memory makes it impossible to open the door by forcibly separating and bridging the connection cables. A built-in rechargeable battery supplies both the electric door opener and the access module in the outdoor station and guarantees keyless access by transponder / code even in the event of a power failure for up to 60 hours. In addition, the MX-DoorMaster also serves as a doorbell indoors.



Due to the significantly greater demand for individually combinable door station individual modules, MOBOTIX no longer offers complete sets for the T26B.

Free App MxBell 2.0 makes the T26B Door Station even smarter

Do not miss a visitor thanks to push notification! MxBell displays the doorbell message of the new T26 IP Video Door Station on the smartphone or tablet. Open the door with it and use the intercom function. Check the last door station and camera recordings in Playback view. With automatic camera detection, secure remote connection over SSL and display of connection status. **MxBell 2.0 is available for free from the App Store and the Google Play Store (iOS 8 / Android 4.4+).**

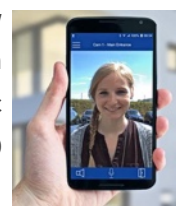

MOBOTIX T26B Door Station and Access Modules: Ordering Information

Order Number	EAN	Description
Mx-T26B-6D016	4047438032025	Hemispheric IP door station camera with 6 Megapixel Moonlight Sensor, color (day) • ONVIF-S compliant Mx6 system platform (2nd generation) with H.264, MxPEG+ and M-JPEG • HD premium fisheye lens B016 (focal length 1.6 mm, f/2.0, 180° x 180°) • Max. image size: 6MP (3072 x 2048) • IP65, -30 to 50°C (-22 to 122°F) • Internal DVR: 4 GB microSD • LED lighting strips, two buttons (doorbell, outdoor light), temperature sensor, shock • detector, MxActivitySensor, MxAnalytics, ethernet patch cable 0.5 m/1.6 ft • Interfaces: Ethernet 10/100 (RJ45 and LSA), MxBus, USB • Color: White
Mx-T26B-6D016-b	4047438032049	like Mx-T26B-6D016, but in black color
Mx-T26B-6D016-s	4047438032063	like Mx-T26B-6D016, but in silver color
Mx-T26B-6D016-d	4047438032087	like Mx-T26B-6D016, but in dark gray color
Mx-T26B-6N016	4047438032032	Hemispheric IP door station camera with 6 Megapixel Moonlight Sensor, B/W (night) • ONVIF-S compliant Mx6 system platform (2nd generation) with H.264, MxPEG+ and M-JPEG • HD premium fisheye lens B016 (focal length 1.6 mm, f/2.0, 180° x 180°) • Max. image size: 6MP (3072 x 2048) • IP65, -30 to 50°C (-22 to 122°F) • Internal DVR: 4 GB microSD • LED lighting strips, two buttons (doorbell, outdoor light), temperature sensor, shock • detector, MxActivitySensor, MxAnalytics, ethernet patch cable 0.5 m/1.6 ft • Interfaces: Ethernet 10/100 (RJ45 and LSA), MxBus, USB • Color: White
Mx-T26B-6N016-b	4047438032056	like Mx-T26B-6D016, but in black color
Mx-T26B-6N016-s	4047438032070	like Mx-T26B-6D016, but in silver color
Mx-T26B-6N016-d	4047438032094	like Mx-T26B-6D016, but in dark gray color
Mx-A-KEYC	4047438034135	Keypad access module for MOBOTIX T26 IP Video Door Stations • Incl. one admin and five user RFID cards • Doorbell function and mailbox control • Integrated RFID technology for keyless entry • Powered by the door camera via MxBus • Up to 60 hrs backup power supply using MX-DoorMaster (accessory) • Protection class IP65, -30 to 50°C / -22 to 122°F • Color: White
Mx-A-KEYC-b	4047438034128	like Mx-A-KEYC, but in black color
Mx-A-KEYC-s	4047438034104	like Mx-A-KEYC, but in silver color
Mx-A-KEYC-d	4047438034111	like Mx-A-KEYC, but in dark gray color
Mx-A-BELLC	4047438034067	BellRFID access module for MOBOTIX T26 IP Video Door Stations • For usage with any BellRFID Bell Button Set (to be ordered individually) • Incl. one admin and five user RFID cards • Doorbell function and mailbox control • Integrated RFID technology for keyless entry • Powered by the door camera via MxBus • Up to 60 hrs backup power supply using MX-DoorMaster (accessory) • Protection class IP65, -30 to 50°C / -22 to 122°F • Color: White
Mx-A-BELLC-b	4047438034074	like Mx-A-BELLC, but in black color
Mx-A-BELLC-s	4047438034098	like Mx-A-BELLC, but in silver color
Mx-A-BELLC-d	4047438034081	like Mx-A-BELLC, but in dark gray color